

# S-type Mounting Plates

For all S-type concealed hinges

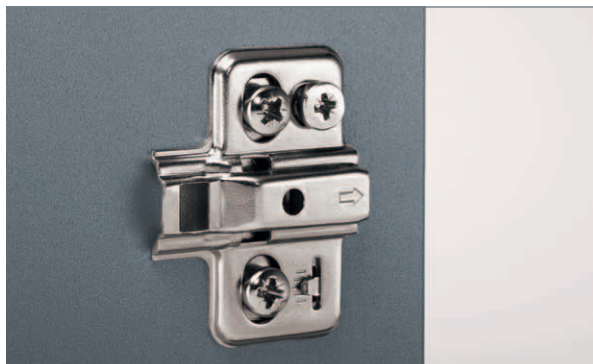
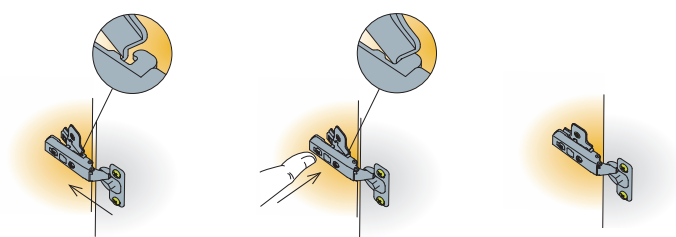

Cam adjustable  
mounting plate

Drilling pattern

Dimensions

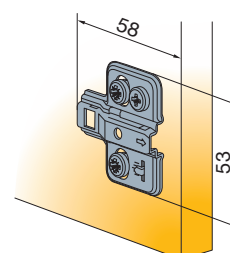
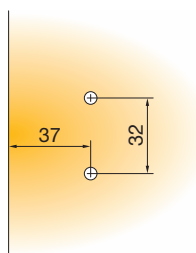

200 Pcs

Made of steel

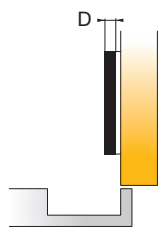

Mounting plate thickness

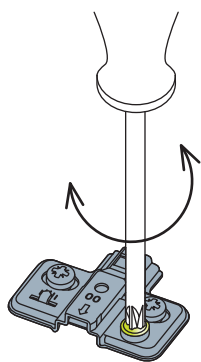

Height adjustment +/- 2mm

Mounting plate type	13	15			10.5	
Mounting plate thickness (D)						
Item number	Item number	Item number	Item number	Item number	Item number	
0mm	244-0258-050	244-0261-050	*244-0264-050	*244-0342-050	244-0270-050	
2mm	244-0259-050	244-0262-050	*244-0265-050	*244-0343-050	244-0271-050	
3mm	244-0260-050	244-0263-050	*244-0266-050	*244-0344-050	244-0272-050	
* Available upon special request → see page 0.3						

Legend of mounting plate type symbols



13

Pre-mounted  
13mm euro screws



15

Pre-mounted  
15mm euro screws

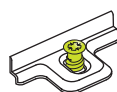

Pre-mounted  
chipboard screws

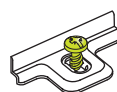

Machine  
insertion ready

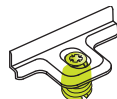

10.5

Pre-mounted  
10.5mm  
expanding dowels

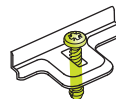

# S-type Mounting Plates

For all S-type concealed hinges

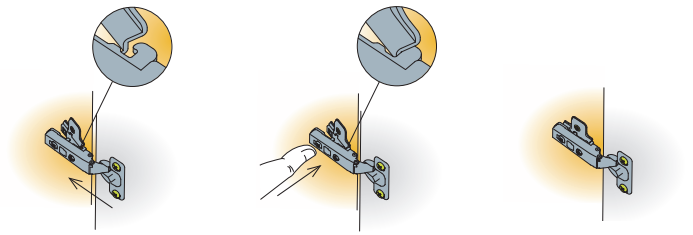

Steel mounting plates

Drilling pattern

Dimensions

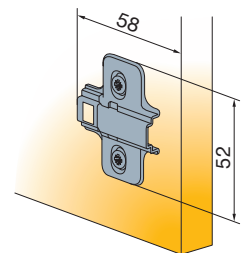
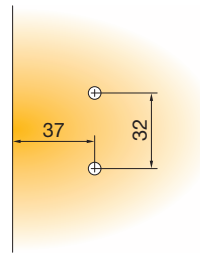

200 Pcs

Made of steel

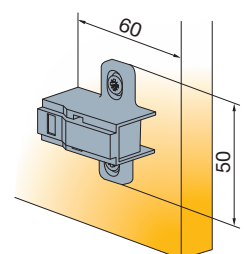
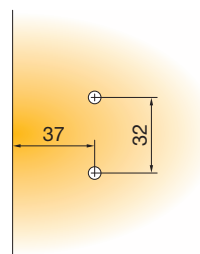

200 Pcs

Made of zinc

Fixing screws for mounting plates  
*If not pre-mounted*

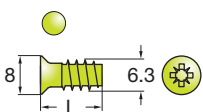

Euro screws  
821-6304-050 L=11  
821-6323-050 L=13  
821-6332-050 L=15

5000 Pcs

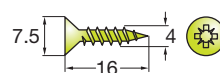

Chipboard screws  
820-6328-050

10000 Pcs

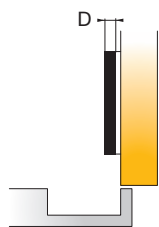

Mounting plate thickness

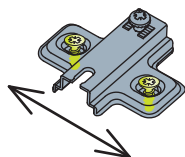

Height adjustment +/- 2mm

Mounting plate type								
Mounting plate thickness (D)								
Item number								
0mm	244-1136-050	*244-1233-050	244-0Z26-050	244-0134-050	244-0118-050	*244-0136-050	*244-0166-050	244-0P26-050
1mm	244-1137-050	*244-1228-050		244-0561-050		*244-0565-050	*244-0567-050	
2mm	244-1138-050	*244-1229-050	244-0Z63-050	244-0562-050	244-0120-050	*244-0566-050	*244-0568-050	244-0V19-050
3mm	244-1139-050	*244-1234-050		244-0135-050	244-0119-050	*244-0137-050	*244-0167-050	244-0P27-050
6mm	244-1645-050				244-0Z51-050			
* Available upon special request → see page 0.3			* Mounting plates with pre-mounted 7.5mm expanding dowels available upon special request → see page 0.3					
9mm	244-3651-650			244-0M33-650	244-0P29-650			
18mm	244-3016-650			244-0085-650	244-0095-650			
* Available upon special request → see page 0.3								

Legend of mounting plate type symbols

Screw on ready for euro screws ← s crews	Screw on ready for chipboard screws	Pre-mounted 11mm euro screws	Pre-mounted 13mm euro screws	Pre-mounted 15mm euro screws	Pre-mounted chipboard screws	Machine insertion ready	Pre-mounted 10.5mm expanding dowels

# S-type

## Face Frame

## Mounting Plates

For all S-type concealed hinges

Drilling pattern

Dimensions

Face frame adapter for  
S-type hinges

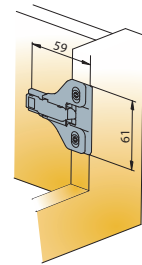
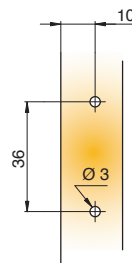

 200 Pcs    Made of zinc alloy

Face frame adapter for  
S-type hinges  
cam adjustable

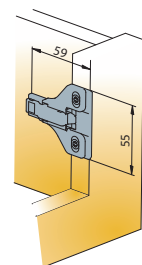
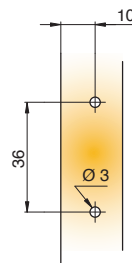

 200 Pcs    Made of zinc alloy

Fixing screw for mounting plates  
*If not pre-mounted*

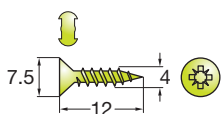

Chipboard screws  
820-6328-050

 10000 Pcs

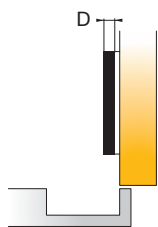

Mounting plate thickness

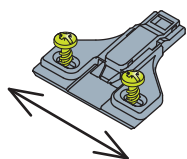

Height adjustment +/- 2mm

Mounting plate type		
Mounting plate thickness (D)	Item number	
		
0mm	<b>244-3653-650</b>	
3mm	<b>244-3654-650</b>	
6mm	<b>244-3655-650</b>	
0mm	<b>248-3600-650</b>	
3mm	<b>248-3603-650</b>	

Legend of mounting plate type symbols



Screw-on ready for chipboard screws  
 ← screws

